



REPAIR MANUAL

GENESIS

SERVICE REPAIR KITS

RELEASED: 4-17-98
REVISED:

VALVE MODEL NUMBER

G X X X XX - XXX - X

OPTION	REBUILD KIT	GASKET KIT
NON-PLUG-IN		
GN12	118820-3	118824
GN13	118822-3	118824
GN14	118820-4	118824
GN17	118821-3	118824
GN18	118822-4	118824
GN19	118821-4	118824
PLUG IN		
GP12	118820-1	118823
GP13	118822-1	118823
GP14	118820-2	118823
GP17	118821-1	118823
GP18	118822-2	118823
GP19	118821-2	118823

PRESSURE REGULATOR		
MODEL	REBUILD KIT	PRESS. ADJ. KIT
118573-X2	119213	119212-30
118573-X3	119213	119212-60
118573-X4	119213	119212-120
118573-X5	119213	119212-30
118573-X6	119213	119212-60
118573-X7	119213	119212-120

SOLENOID COILS (PLUG IN VALVES ONLY)				
OPTION	VOLTAGE	COIL OPT. -A, -H	COIL OPT. -D, -J	COIL OPT. -L, -P
000	NO COIL	NONE	NONE	NONE
005	5	NONE	NONE	119394-37
012	12	NONE	119393-38	119394-38
024	24	119393-38	119393-39	119394-39
048	48	119393-39	NONE	NONE
120	120	119393-33	119393-35	NONE
240	240	119393-35	NONE	NONE

NUMBER OF SOLENOID COILS REQUIRED PER VALVE (PLUG IN VALVES ONLY)	
OPERATOR OPTION	NUMBER OF KITS REQUIRED
PD	NONE
PS	NONE
SD	2
SS	1
ND	2
NS	1
AD	2
AS	1
MD	2
MS	1

NOTE:

- THE REBUILD KIT AND GASKET KIT SELECTION IS DETERMINED BY THE FIRST FOUR POSITIONS IN THE MODEL NUMBER [GX1X] XX-XXX-X, (THE POSITIONS WITHIN THE BRACKETS).
- THE SOLENOID COIL IS DETERMINED BY THE COIL VOLTAGE OPTION CODE IN THE MODEL NUMBER GX1XXX-[XXX-X], (THE POSITIONS WITHIN THE BRACKETS).
- THE NUMBER OF SOLENOID COILS REQUIRED IS DETERMINED BY THE OPERATOR OPTION CODE IN THE MODEL NUMBER GX1X[XX]-XXX-X, (THE POSITIONS WITHIN THE BRACKETS).
- THE REBUILD KIT INCLUDES THE GASKET KIT.



INGERSOLL-RAND COMPANY
ONE ARO CENTER • BRYAN, OHIO 43506-0151
☎ (419) 636-4242 • FAX (419) 633-1674 ©1998 • PRINTED IN U.S.A.

INGERSOLL-RAND
FLUID PRODUCTS

PLUG-IN VALVE

VALVE MODEL	LIGHT
GP1XXX-005-X	119432-1
GP1XXX-012-X	119432-2
GP1XXX-024-X	119432-3
GP1XXX-120-X	119432-4
GP1XXX-240-X	119432-5

▲ Included in 118823 gasket kit.

■ Included in rebuild kit (see page 1).

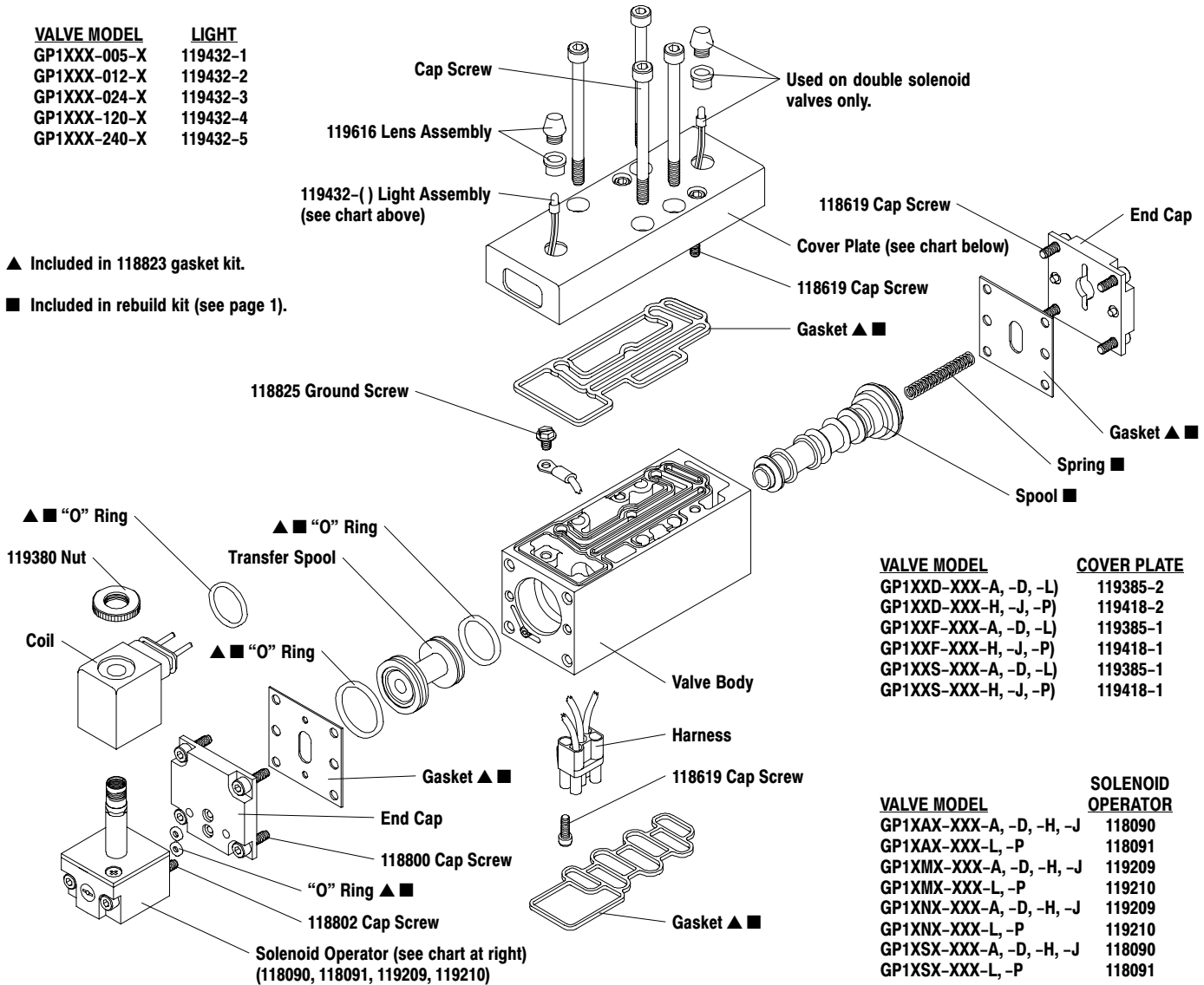

VALVE MODEL	COVER PLATE
GP1XXD-XXX-A, -D, -L)	119385-2
GP1XXD-XXX-H, -J, -P)	119418-2
GP1XXF-XXX-A, -D, -L)	119385-1
GP1XXF-XXX-H, -J, -P)	119418-1
GP1XXS-XXX-A, -D, -L)	119385-1
GP1XXS-XXX-H, -J, -P)	119418-1

VALVE MODEL	SOLENOID OPERATOR
GP1XAX-XXX-A, -D, -H, -J	118090
GP1XAX-XXX-L, -P	118091
GP1XMX-XXX-A, -D, -H, -J	119209
GP1XMX-XXX-L, -P	119210
GP1XNX-XXX-A, -D, -H, -J	119209
GP1XNX-XXX-L, -P	119210
GP1XSX-XXX-A, -D, -H, -J	118090
GP1XSX-XXX-L, -P	118091

DISASSEMBLY/ASSEMBLY INSTRUCTIONS

DISASSEMBLY

1. Remove valve from service and disconnect all lines, inlet and outlet.
2. Remove two cap screws (118802), releasing solenoid operator and coil from valve body.
3. Disconnect the coil wires from the wiring harness.
4. To remove coil from solenoid operator, remove nut (119380), releasing coil.
5. Remove four cap screws in each end cap, releasing end caps and gaskets. NOTE: Notice the location of the cavity on the inside of the end cap. This will be important at the time of assembly.
6. Remove transfer spool (118732).
7. Using a wooden or plastic dowel, push spool out of valve body.
8. Remove two cap screws (118619), releasing cover plate and gasket.

ASSEMBLY

1. Grease i.d. of valve body and assemble spool and spring into body. Assemble small end of spool into valve body first.
2. Grease gasket and assemble gasket and end cap to valve body, securing with four cap screws. NOTE: Torque screws to 22 – 38 in. lbs (2.5 – 4.3 Nm).
3. Grease "O" rings and assemble to transfer spool (118732).
4. Assemble transfer spool (118732) to valve body. Assemble with small end of spool into valve body first.

5. Grease gasket and assemble gasket and end cap to valve body, securing with four cap screws (118800). NOTE: Torque screws to 22 – 38 in. lbs (2.5 – 4.3 Nm).
6. Assemble gasket to top of valve body.
7. Assemble wire end of wire harness up thru valve body, securing harness with cap screw (118619). NOTE: Torque screw to 8 – 18 in. lbs (0.9 – 2.0 Nm).
8. Secure ground wire with ground screw (118825). NOTE: Torque screw to 5 – 15 in. lbs (0.6 – 1.7 Nm).
9. Feed wires thru cover plate. Short wires toward front end (transfer spool end) of valve and long wires toward rear end of valve (double solenoid only).
10. Insert four mounting screws thru cover plate and body.
11. Assemble cover plate to valve body, securing with two cap screws (118619). NOTE: Torque screws to 26 – 36 in. lbs (2.9 – 4.1 Nm).
12. Assemble coil to solenoid operator, securing with nut (119380).
13. Grease and assemble "O" ring to groove in coil.
14. Connect wires in cover plate to coil. Install lights (if used) and connect wires.
15. Grease two "O" rings and assemble to end cap.
16. Assemble solenoid operator and components to valve body, inserting wires into cover plate.
17. Secure solenoid operator with two cap screws (118802). NOTE: Torque screws to 13 – 23 in. lbs (1.5 – 2.6 Nm).
18. Grease and assemble gasket to bottom of valve body.

PLUG-ON VALVE

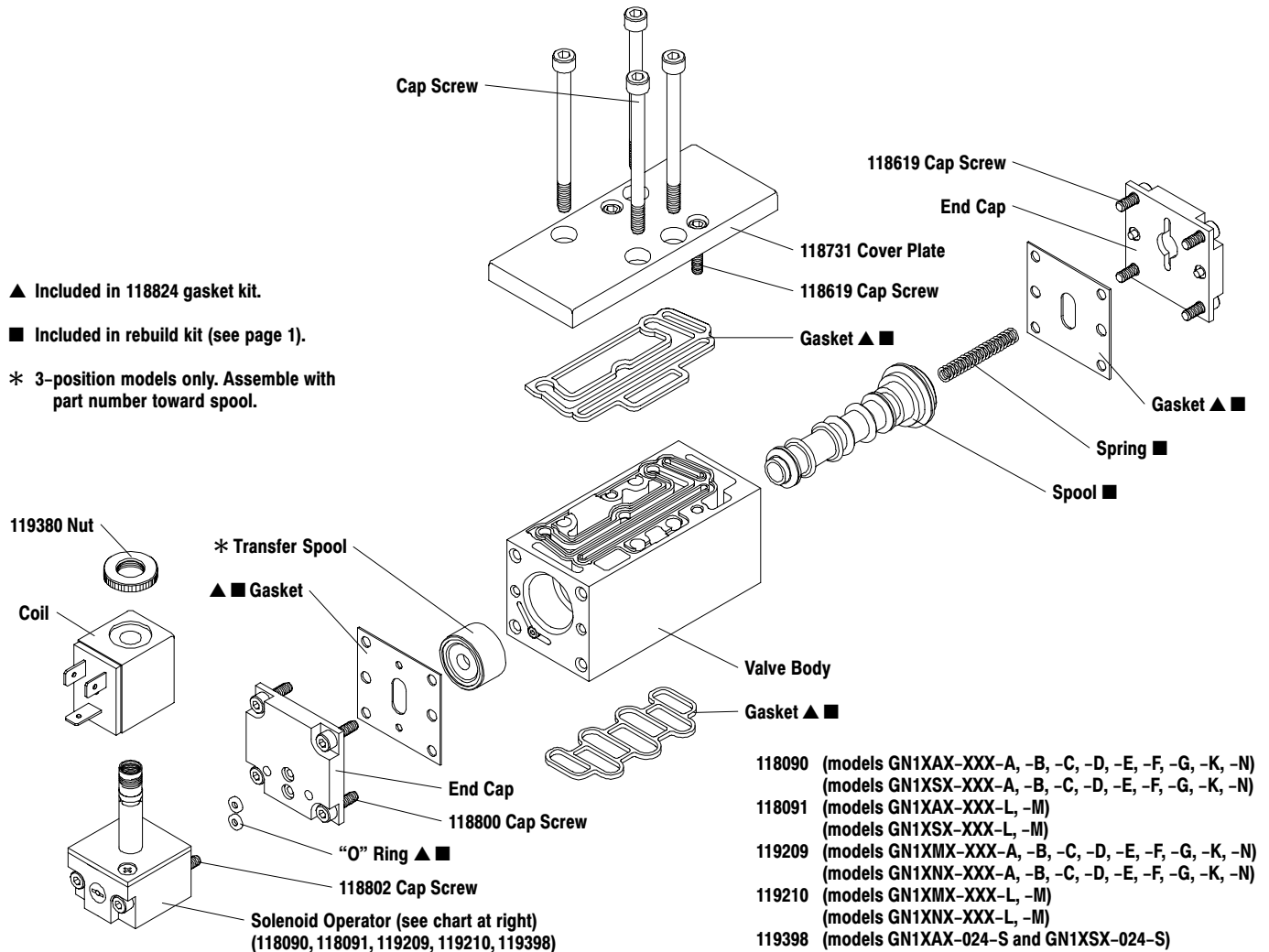

DISASSEMBLY/ASSEMBLY INSTRUCTIONS

DISASSEMBLY

1. Remove valve from service and disconnect all lines, inlet and outlet.
2. Remove nut (119380), releasing coil.
3. Remove two cap screws (118802), releasing solenoid operator from valve body.
4. Disconnect four cap screws in each end cap, releasing end caps and gaskets. NOTE: Notice the location of the cavity on the inside of the end cap. This will be important at the time of assembly.
5. Remove the transfer spool.
6. Using a wooden or plastic dowel, push spool out of valve body.
7. Remove two cap screws (118619), releasing cover plate and gasket.

ASSEMBLY

1. Grease i.d. of valve body and assemble spool and spring into body. Assemble small end of spool into valve body first.
2. Grease gasket and assemble gasket and end cap to valve body, securing with four cap screws. NOTE: Torque screws to 22 – 38 in. lbs (2.5 – 4.3 Nm).
3. Grease gasket and assemble transfer spool, gasket and end cap to valve body, securing with four cap screws (118800). NOTE: Torque screws to 22 – 38 in. lbs (2.5 – 4.3 Nm).
4. Grease gasket and assemble to top of valve body.
5. Insert four mounting screws thru cover plate and body.
6. Assemble cover plate to valve body, securing with two cap screws (118619). NOTE: Torque screws to 26 – 36 in. lbs (2.9 – 4.1 Nm).
7. Grease two "O" rings and assemble to end cap.
8. Assemble solenoid operator to end cap, securing with two cap screws (118802). NOTE: Torque screws to 13 – 23 in. lbs (1.5 – 2.6 Nm).
9. Assemble coil to solenoid operator, securing with nut (119380).
10. Grease and assemble gasket to bottom of valve body.

PRESSURE REGULATOR

* INCLUDED IN KIT 119213

▲ AVAILABLE IN KIT ONLY

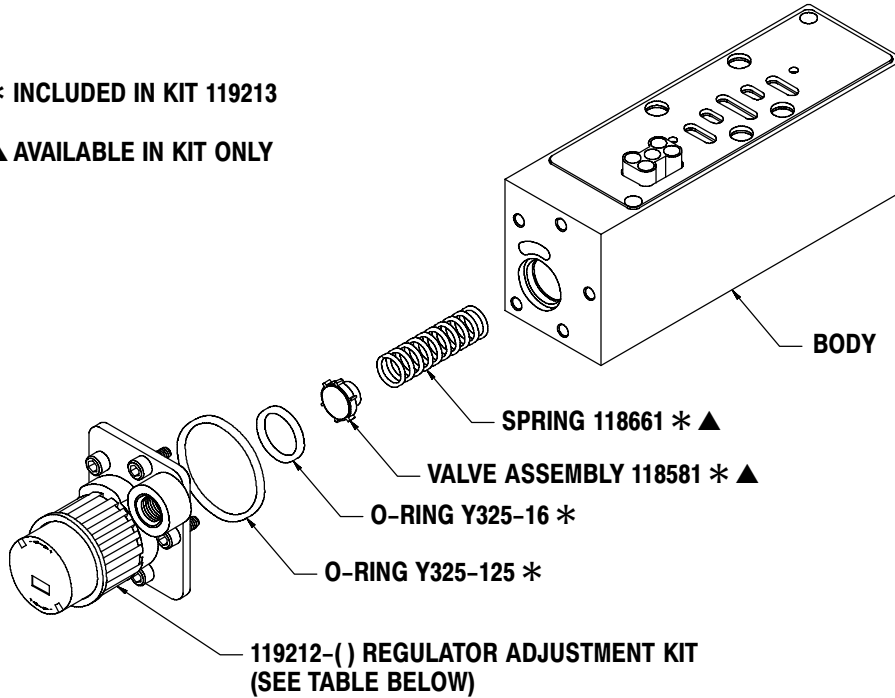

REGULATOR NO.	REG. ADJ. KIT	GAUGE ☆	DESCRIPTION
118573-N2	119212-30	119219-60	PLUG-ON 30 P.S.I.G.
118573-N3	119212-60	119219-100	PLUG-ON 60 P.S.I.G.
118573-N4	119212-120	119219-160	PLUG-ON 120 P.S.I.G.
118573-N5	119212-30	NONE	PLUG-ON 30 P.S.I.G.
118573-N6	119212-60	NONE	PLUG-ON 60 P.S.I.G.
118573-N7	119212-120	NONE	PLUG-ON 120 P.S.I.G.
118573-P2	119212-30	119219-60	PLUG-IN 30 P.S.I.G.
118573-P3	119212-60	119219-100	PLUG-IN 60 P.S.I.G.
118573-P4	119212-120	119219-160	PLUG-IN 120 P.S.I.G.
118573-P5	119212-30	NONE	PLUG-IN 30 P.S.I.G.
118573-P6	119212-60	NONE	PLUG-IN 60 P.S.I.G.
118573-P7	119212-120	NONE	PLUG-IN 120 P.S.I.G.

☆ NOT SHOWN

DISASSEMBLY/ASSEMBLY INSTRUCTIONS

DISASSEMBLY

1. Remove five cap screws, releasing regulator adjustment kit 119212-().
2. Remove "O" rings (Y325-125 and Y325-16).
3. Remove valve assembly (118581) and spring (118661).

ASSEMBLY

1. Assemble spring (118661) and valve assembly (118581) into body.
2. Grease "O" ring (Y325-16) and assemble to body.
3. Grease "O" ring (Y325-125) and assemble to groove in regulator housing.
4. Assemble regulator adjustment kit 119212-() to body, securing with five cap screws. Torque to 15 - 25 in. lbs (1.7 - 2.8 Nm).